

**MODEL: AF32 HOUSING ASSEMBLY**

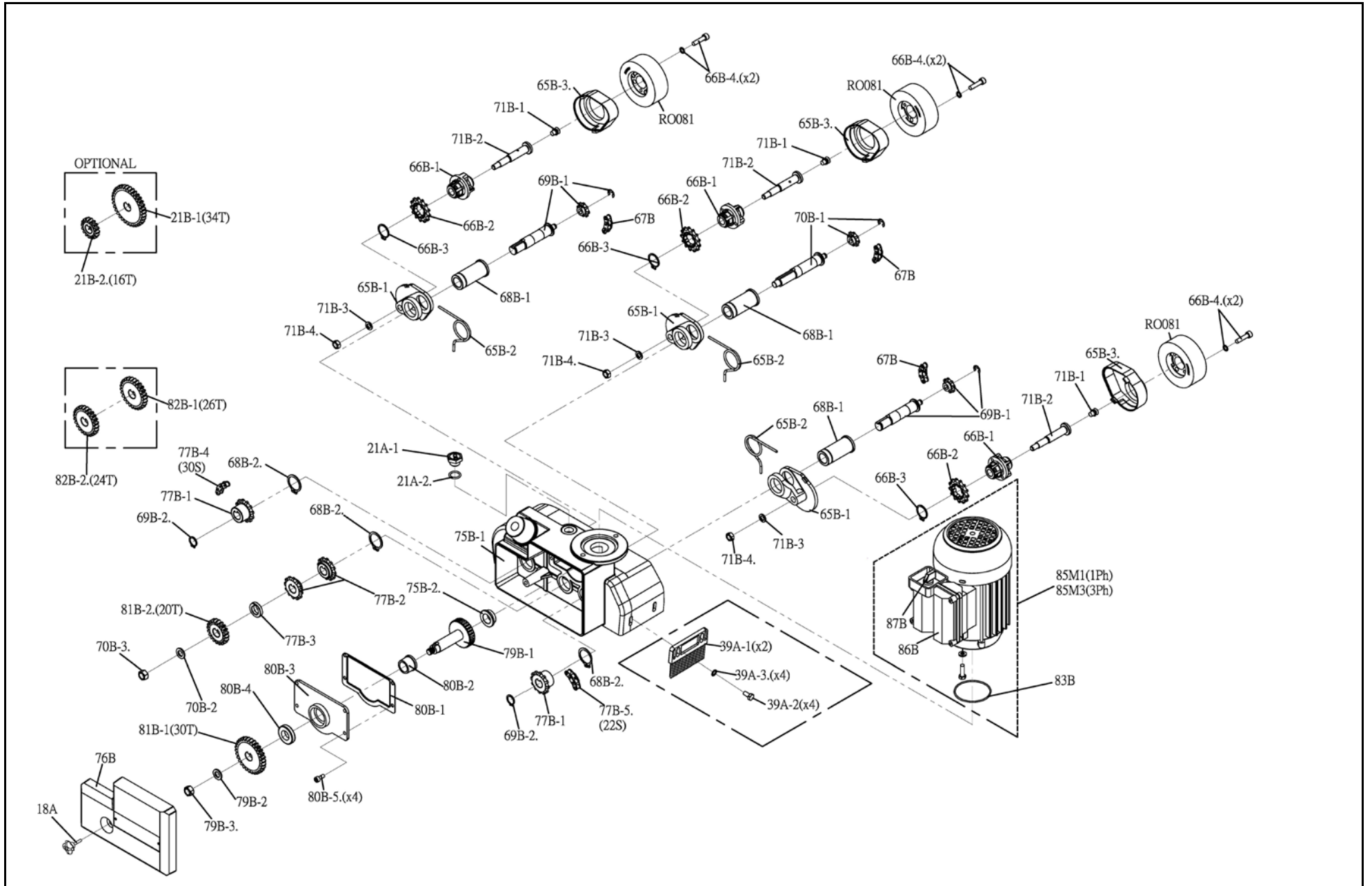

Part No.	Code No.	Description	Q'ty	Part No.	Code No.	Description	Q'ty	Part No.	Code No.	Description	Q'ty
18A	U010051	Knob (M6-1.0Px30L)	1	68B-2.	N510026	Snap Ring (26)	1	79B	79B	Wormgear Shaft Kit	1
21A	21A	Oil-Cap Kit (M16)	1	69B	69B	Sprocket Shaft Kit	2	79B-1	G320016	Wormgear Shaft	1
21A-1	U010008	Oil Cap (16mm)	1	69B-1	G320018A	Sprocket Shaft	1	79B-2	N015925	Flat Washer (3/8"x25x10t)	1
21A-2.	Q010012	"O" Ring (P12)	1	69B-2.	N510015	Snap Ring (15)	1	79B-3.	N11010R	Nut (M10-1.5P)	1
21B	21B	GEAR SET (16T/34T)	1	70B	70B	Sprocket Shaft Kit	1	80B	80B	Wormgear Cover Kit	1
21B-1	A500348	Gear (34T)	1	70B-1	G320017A	Main Sprocket Shaft	1	80B-1	U210007	Oil Seal	1
21B-2.	A500349	Gear (16T)	1	70B-2	N015925	Flat Washer (3/8"x25x10t)	1	80B-2	A500302	Bushing (29Dx23Dx(15+3))	1
39A	39A	Brush Kit	2	70B-3.	N11010R	Nut (M10-1.5P)	1	80B-3	C020322	Wormgear Cover	1
39A-1	U010088	Brush	1	71B	71B	Roller Spindle Kit	3	80B-4	Q021701	Oil Seal (17x32x7t)	1
39A-2	S600612	Hex Screw (M6-1.0Px12)	2	71B-1	T315106	Grease Nipple (M6-1.0Px1.0)	1	80B-5.	S070512	Cap Screw (M5-0.8Px12L)	4
39A-3.	N050057	Lock Washer (1/4"x1.4t)	2	71B-2	G320067	Sprocket Shaft	1	81B	81B	Gear Kit (20T/30T)	1
65B	65B	Sprocket Case Kit	3	71B-3	N030008	Spring Washer (8.3x1.8t)	1	81B-1	A500327	Gear (30T)	1
65B-1	C020047	Sprocket Case	1	71B-4.	N11008R	Nut (M8-1.25P)	1	81B-2.	A500324	Gear (20T)	1
65B-2	N950003	Spring (φ 30x6)	1	75B	75B	Housing Frame Kit (32)	1	82B	82B	Gear Kit (24T/26T)	1
65B-3.	U010054	Case Cap	1	75B-1	C020051	Housing Frame (32)	1	82B-1	A500323	Gear (26T)	1
66B	66B	Roller Supporter Kit	3	75B-2.	A500306	Bushing (φ 29x φ 23x(7+3))	1	82B-2.	A500326	Gear (24T)	1
66B-1	C020334A	Roller Supporter	1	76B	U010031	Housing Cover Kit (AF32)	1	83B	Q010060	O Ring	1
66B-2	A500336	Sprocket (13T)	1	77B	77B	Transmission Kit	1	85M1	85M1	Motor w/ Switch 1/4HP.1PH	1
66B-3	N510022	Snap Ring (22)	1	77B-1	A500303	Sprocket (12Tx3/8")	2	85M3	85M3	Motor w/ Switch 1/4HP.3PH	1
66B-4.	S060625	Cap Screw (M6-1.0Px25L)	2	77B-2	A500307	Double-Sprocket (12T)	2	86B	U010002	Switch Box Kit	1
67B	K330018	Chain (18S)	3	77B-3	A500308	Bushing	1	87B	J120020	Switch (1/4Hp)	1
68B	68B	Tube Kit	3	77B-4	K330030	Chain (30S)	1	RO08	C020302	ROLLER, φ 80x30x1PC	3
68B-1	A500331	Tube	1	77B-5.	K330022	Chain (22S)	1				

MODEL: US01 LIGHT-DUTY UNIVERSAL STAND

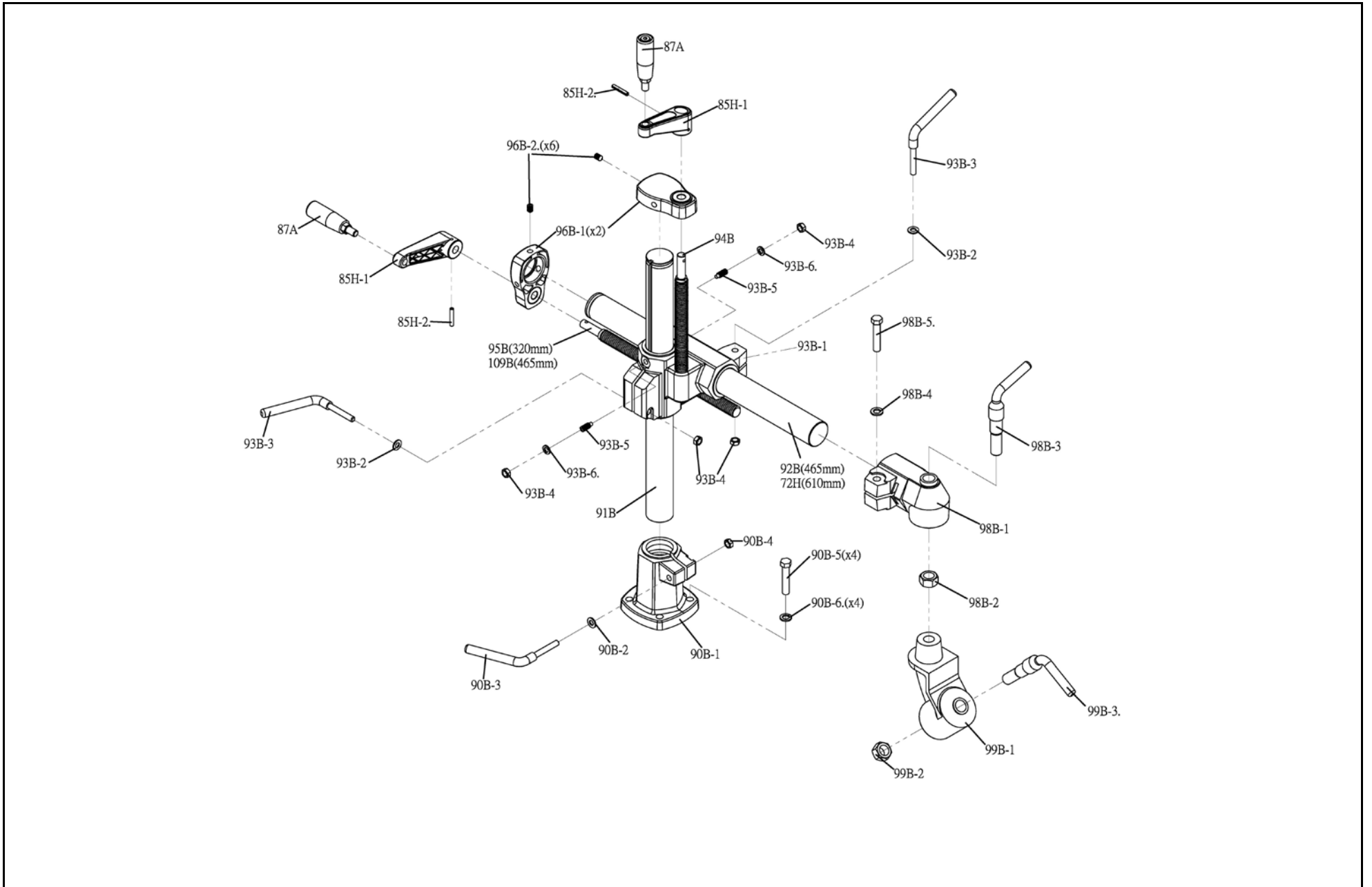

Part No.	Code No.	Description	Q' ty	Part No.	Code No.	Description	Q' ty
72H	G020043	Extension Column (φ 40x610L)	1	93B-5	G000006	Set Screw	2
85H	85H	Handle Kit	2	93B-6.	N030008	Spring Washer	2
85H-1	U010106	Handle	1	94B	G320092	Elevating Screw	1
85H-2.	N810430	Lock Pin	1	95B	G320091	Extension Screw	1
87A	U010011	Handle-Grip (M10-P1.5x70L)	2	96B	96B	Column Cap Kit	2
90B	90B	Base Kit	1	96B-1	C020323A	Column Cap	1
90B-1	A200326	Column Base	1	96B-2.	G000005	Set Screw	3
90B-2	N015816	Flat Washer (5/16"x16)	1	98B	98B	Overarm Cone Kit	1
90B-3	G020012	Set-Lever	1	98B-1	A200328	Overarm Cone	1
90B-4	N11008R	Nut	1	98B-2	N11216R	Nut	1
90B-5	S601050	Hex Screw	4	98B-3	G020011	Lever	1
90B-6.	N030010	Spring Washer	4	98B-4	N015925	Flat Washer (3/8"x25x10t)	1
91B	G020013	Elevating Arm (φ 40x465L)	1	98B-5.	S601050	Hex Screw	1
92B	G020014	Extension Arm (φ 40x465L)	1	99B	99B	Swivel Cone Kit	1
93B	93B	Elevating Bracket Kit	1	99B-1	A200321	Swivel Cone	1
93B-1	A200327	Elevating Bracket	1	99B-2	N11216R	Nut	1
93B-2	N015816	Flat Washer (5/16"x16)	2	99B-3.	G020011	Lever	1
93B-3	G020012	Set-Lever	2	109B	G320228	Extension Screw (465mm)	1
93B-4	N11008R	Nut	4				