

MODEL: EZ300 HOUSING ASSEMBLY

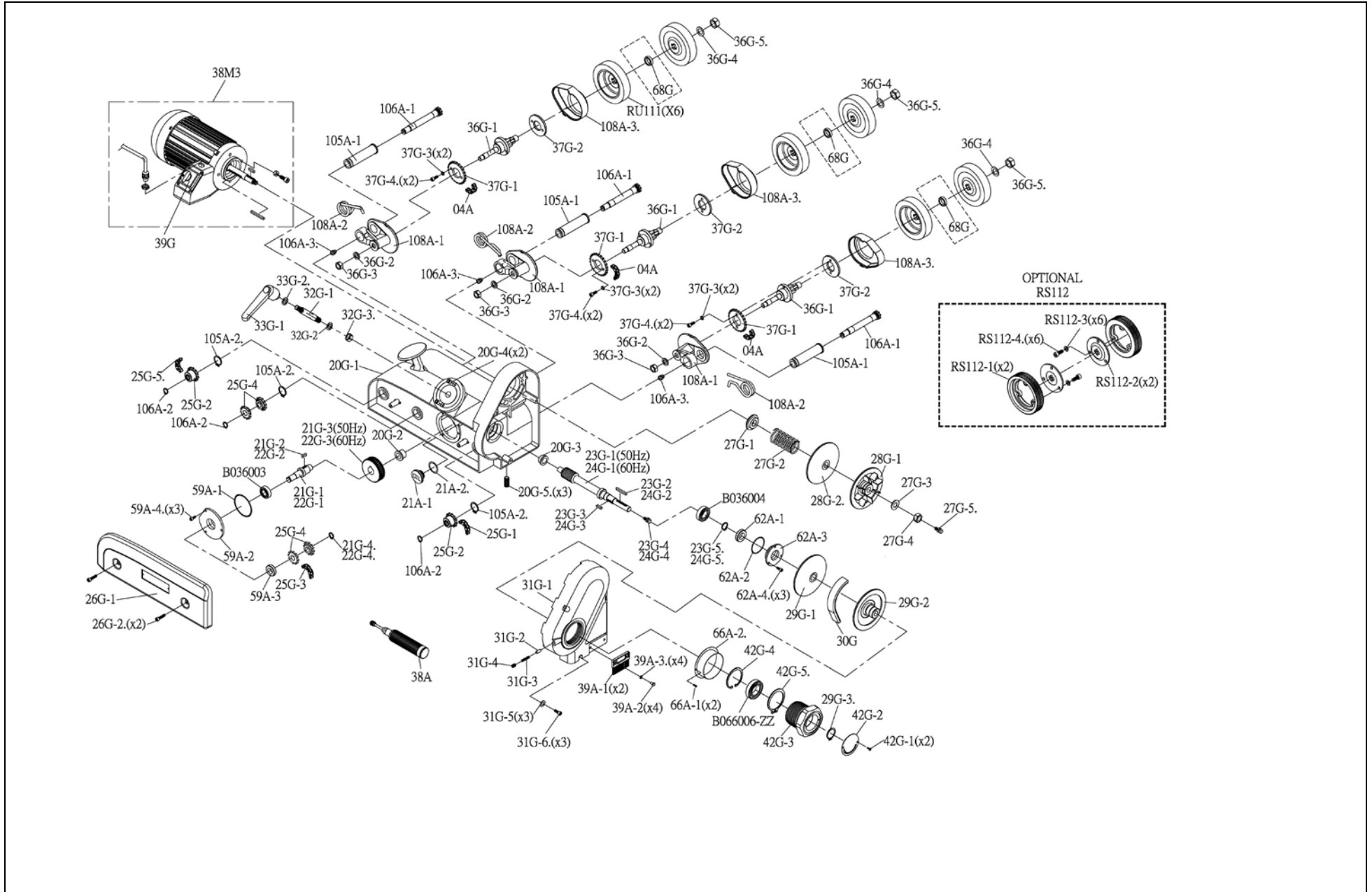

Part No.	Code No.	Description	Q'ty	Part No.	Code No.	Description	Q'ty	Part No.	Code No.	Description	Q'ty
B036003	B036003	Bearing(#6003)	1	26G-2.	S900630	Cap Screw (M6-1.0Px30L)	2	39A-1	U010088	Brush	1
B036004	B036004	Bearing(#6004)	1	27G	27G	Comp. Spring Kit	1	39A-2	S600612	Hex Screw (M6-1.0Px12)	2
B066006-ZZ	B066006-ZZ	Bearing(#6006ZZ)	1	27G-1	G020030	Spring Stopper	1	39A-3.	N050057	Lock Washer (1/4"x1.4t)	2
04A	K330026	Chain (26S)	3	27G-2	N930020	Comp. Spring EZ	1	39G	J120009	EZ Switch	1
21A	21A	Oil-Cap Kit (M16)	1	27G-3	N011225	Flat Washer (M12x25D)	1	42G	42G	Speed Handwheel Kit	1
21A-1	U010008	Oil Cap (16mm)	1	27G-4	N11012H	Nut (M12-1.75P)	1	42G-1	S500406	PH. Screw (M4-0.7Px6L)	2
21A-2.	Q010012	"O" Ring (P12)	1	27G-5.	T315106	Grease Nipple (M6-1.0Px1.0)	1	42G-2	P200030	Fw/Rev Plate	1
20G	20G	Housing Frame Kit (EZ3R)	1	28G	28G	Motor Pulley Kit	1	42G-3	C010324	Speed Handwheel	1
20G-1	C010001	Housing Frame (EZ3R)	1	28G-1	C010011	Fanned Pulley	1	42G-4	N520055	"C" Clip (55)	1
20G-2	A500301	Bushing (29Dx23Dx(9+3))	1	28G-2.	C010007	Motor Pulley	1	42G-5.	N510065	Snap Ring (65)	1
20G-3	A500302	Bushing (29Dx23Dx(15+3))	1	29G	29G	Transmission Pulley Kit	1	59A	59A	Wormgear Cover Kit	1
20G-4	G320043	Bushing	2	29G-1	C010005	Shaft Pulley	1	59A-1	Q010065	"O" Ring (G65)	1
20G-5.	S100610	Set Screw (M6-1.0Px10L)	3	29G-2	C010004	Idle Pulley-L	1	59A-2	C020310	Worm Gear Cover	1
21G	21G	Wormgear Shaft Kit 50Hz	1	29G-3.	N510030	Snap Ring (30)	1	59A-3	Q021701	Oil Seal (17x32x7t)	1
21G-1	G320038	Wormgear Shaft	1	30G	K260002	Trans-Belt (535x23x8)	1	59A-4.	S070516	Cap Screw (M5-0.8Px16L)	3
21G-2	K420618	Key (6x6x18L)	1	31G	31G	Pulley Cover Kit (EZ)	1	62A	62A	Wormgear Shaft Cap Kit	1
21G-3	C120008	Worm Gear (30T, 50Hz)	1	31G-1	C010003	Transmission Guard Cover	1	62A-1	Q023501	Oil Seal (20x35x7t)	1
21G-4.	N510015	Snap Ring (15)	1	31G-2	T401001	Screw Thruster (6.35x17L)	1	62A-2	Q010042	"O" Ring (P42)	1
22G	22G	Worm Gear Kit 60Hz	1	31G-3	N930001	L-Stop Spring (φ 5x28)	1	62A-3	C010330	Wormgear Shaft Cap	1
22G-1	G320038	Wormgear Shaft	1	31G-4	G000005	Set Screw (M8-1.25Px12L)	1	62A-4.	S900512	Cap Screw (M5-0.8Px12L)	3
22G-2	K420618	Key (6x6x18L)	1	31G-5	N030006	Spring Washer M6	3	66A	66A	Speed Indicator Kit	1
22G-3	C120001	Worm Gear (38T, 60Hz)	1	31G-6.	S900645	Cap Screw (M6-1.0Px45L)	3	66A-1	S500310	PH. Screw (M5-0.8Px10L)	2
22G-4.	N510015	Snap Ring (15)	1	32G	32G	Lock Stud Kit (M14-2.0P)	1	66A-2.	U010066A	Speed Indicator	1
23G	23G	Wormgear Shaft Kit 50Hz	1	32G-1	G020025	Lock Stud (M14-2.0P)	1	68G	G020027	EZ Roller Spacer	3
23G-1	G320040	Wormgear Shaft (2.25, 50Hz)	1	32G-2	N030014	Spring Washer (M14)	1	105A	105A	Tube Kit	3
23G-2	K420535	Key (5x5x35L)	1	32G-3.	N11014R	Nut (M14-2.0P)	1	105A-1	E270006	Tube	1
23G-3	K420520	Key (5x5x20L)	1	33G	33G	Pull-Handle Kit (M12)	1	105A-2.	N510026	Snap Ring (26)	1
23G-4	T315106	Grease Nipple (M6-1.0Px1.0)	1	33G-1	T060001	Pull Handle (M12x100L)	1	106A	106A	Sprocket Shaft Kit	3
23G-5.	N510020	Snap Ring (20)	1	33G-2.	N011225	Flat Washer (M12x25D)	1	106A-1	G320132	Sprocket Shaft	1
24G	24G	Wormgear Shaft Kit 60Hz	1	36G	36G	Roller Spindle Kit	3	106A-2	N510015	Snap Ring (15)	1
24G-1	G320039	Wormgear Shaft (1.75, 60Hz)	1	36G-1	G320041	Roller Spindle	1	106A-3.	T315106	Grease Nipple (M6-1.0Px1.0)	1
24G-2	K420535	Key (5x5x35L)	1	36G-2	A510003	Spacer	1	108A	108A	Sprocket Case Kit	3
24G-3	K420520	Key (5x5x20L)	1	36G-3	N11012H	Nut (M12-1.75P)	1	108A-1	C020049A	Sprocket Case w/ Bushing (EZ)	1
24G-4	T315106	Grease Nipple (M6-1.0Px1.0)	1	36G-4	N011630	Flat Washer (M16x30Dx3t)	1	108A-2	N950001	Spring (φ 38x11.4)	1
24G-5.	N510020	Snap Ring (20)	1	36G-5.	N11016R	Nut (M16-2.0P)	1	108A-3.	U010052	Case Cap	1
25G	25G	Transmission Kit (EZ3R)	1	37G	37G	Sprocket Kit	3	RU111	C020352	PU Roller, φ 120x25x1	6
25G-1	K330036	Chain (36S)	1	37G-1	A500309	Sprocket	1	RS112	RS112	Serrated Rolle, φ 120x25x2	3
25G-2	A500303	Sprocket (12Tx3/8")	2	37G-2	G020026	Anti-Dust Plate	1	RS112-1	A470015	Serrated Roller, φ 120x25	2
25G-3	K330038	Chain (38S)	1	37G-3	N050057	Lock Washer (1/4"x1.4t)	2	RS112-2	C020353	Roller Wheel	2
25G-4	A500307	Double-Sprocket (12T)	4	37G-4.	S900620	Cap Screw (M6-1.0Px20L)	2	RS112-3	N030008	Spring Washer (8.3x1.8t)	6
25G-5.	K330040	Chain (40S)	1	38A	T344001	Grease Gun	1	RS112-4.	S600820	Hex Screw (M8-1.25Px20L)	6
26G	26G	Housing Cover Kit (EZ3R)	1	38M3	38M3	Motor w/ Switch 3/4HP.3	1				
26G-1	C010002	Housing Cover (EZ3R)	1	39A	39A	Brush Kit	2				

MODEL: SS13 HEAVY-DUTY UNIVERSAL STAND

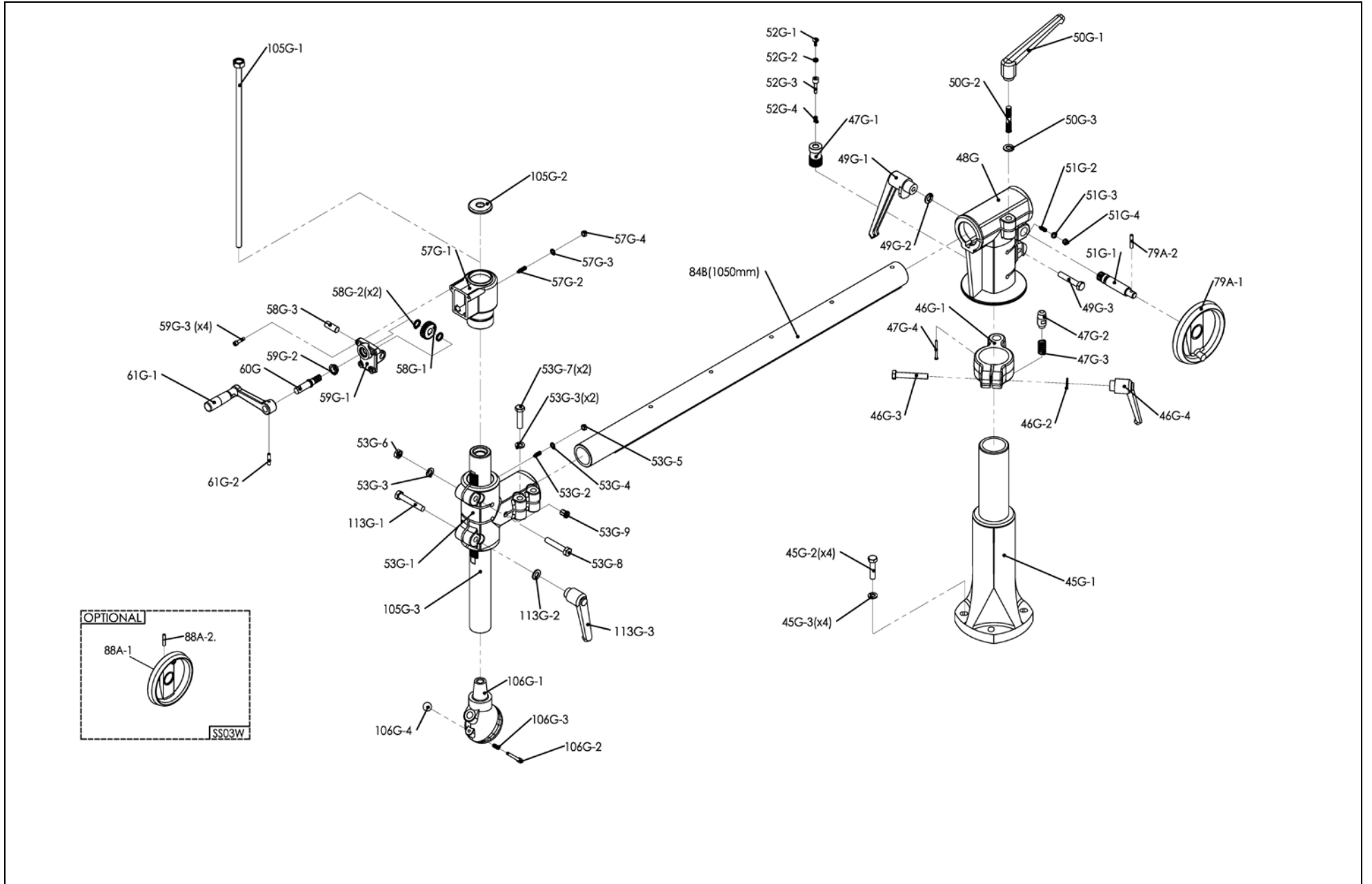

Part No.	Code No.	Description	Q'ty	Part No.	Code No.	Description	Q'ty	Part No.	Code No.	Description	Q'ty
45G	45G	Column Base	1	51G-4.	N11008R	Nut (M8-1.25P)	1	59G-2	A500317	T. Bushing (φ20xφ15x3+5.5)	1
45G-1	A470005	Column Base	1	52G	52G	Memo-Lock Pin Kit	1	59G-3.	S060625	Cap Screw (M6-1.0Px25L)	4
45G-2	S601250	Hex Screw (M12-1.75Px50L)	4	52G-1	S010616	Carriage Screw (M6-1.0Px16L)	1	60G	G320047	Handle Axle	1
45G-3.	N030012	Spring Washer (M12)	4	52G-2	N11006R	Nut (M6-1.0P)	1	61G	61G	Elevating Handle Kit	1
46G	46G	Memo-Lock Base Kit	1	52G-3	G320046	Lock-Pin	1	61G-1	T050001	Elevating Handle	1
46G-1	A470006	Memo-Lock Base	1	52G-4.	N930006	Spring (φ1x29)	1	61G-2.	N810630	Lock Pin (6x30L)	1
46G-2	N011225	Flat Washer (M12x25D)	1	53G	53G	Elevating Bracket Kit	1	79A	79A	Handwheel Kit	1
46G-3	S601275	Hex Screw (M12-1.75Px75L)	1	53G-1	A470008	Elevating Bracket	1	79A-1	U010082	Extension Wheel	1
46G-4.	T060001	Pull Handle (M12x100L)	1	53G-2	G000006	Set Screw (M8-1.25Px20L)	1	79A-2.	N810636	Lock Pin (6x36L)	1
47G	47G	Memo-Lock Support Kit	1	53G-3	N030012	Spring Washer (M12)	3	84B	E580003A	Over Arm Kit (1050mm)	1
47G-1	G320045	Memo-Lock Tube	1	53G-4	N030008	Spring Washer (8.3x1.8t)	1	88A	88A	Extension Handwheel Kit	1
47G-2	G320044	Memo-Lock Support	1	53G-5	N11008R	Nut (M8-1.25P)	1	88A-1	C020312	Handwheel	1
47G-3	N930005	Spring (φ1.5x31.5)	1	53G-6	N11012H	Nut (M12-1.75P)	1	88A-2.	N810636	Lock Pin (6x36L)	1
47G-4.	S500550	PH. Screw (M5-0.8Px50L)	1	53G-7	S601250	Hex Screw (M12-1.75Px50L)	2	105G	105G	Elevating Column Kit	1
48G	A470007	Extension Bracket	1	53G-8	S601265	Hex Screw (M12-1.75Px65L)	1	105G-1	G000054	Set Screw (M16-1.5Px60L)	1
49G	49G	Memo-Handle Kit	1	53G-9.	U010119	Cord Sheath	1	105G-2	G020064	Anti-Dust Shield, EZ	1
49G-1	A470011	Memo-Handle	1	57G	57G	Elevating Support Kit	1	105G-3.	E500004	Elevating Column	1
49G-2	N011225	Flat Washer (M12x25D)	1	57G-1	A470009	Elevating Support	1	106G	106G	Pivot-Joint Kit	1
49G-3.	S601265	Hex Screw (M12-1.75Px65L)	1	57G-2	G000007	Set Screw (M8-1.25Px25L)	1	106G-1	A470039	Pivot-Joint	1
50G	50G	Handle Kit	1	57G-3	N030008	Spring Washer (8.3x1.8t)	1	106G-2	G320042	Pivot Lock-Pin	1
50G-1	A470012	Handle	1	57G-4.	N11008R	Nut (M8-1.25P)	1	106G-3	N930007	Spring (φ0.9x23)	1
50G-2	G320102	Stud (M12-1.75Px70L)	1	58G	58G	Bevel Gear Kit	1	106G-4.	T005022	Pin Knob (φ22-M6-P1.0)	1
50G-3.	N011225	Flat Washer (M12x25D)	1	58G-1	A500004	Bevel Gear	1	113G	113G	Pull-Handle Kit	1
51G	51G	Handwheel Pinion Kit	1	58G-2	A500354	Spacer (φ21xφ14x2.8t)	2	113G-1	S601275	Hex Screw (M12-1.75Px75L)	1
51G-1	G020029	Pinion	1	58G-3.	G320048	Gear Shaft	1	113G-2	N011225	Flat Washer (M12x25D)	1
51G-2	G000007	Set Screw (M8-1.25Px25L)	1	59G	59G	Elevating-Support Cover Kit	1	113G-3.	T060001	Pull Handle (M12x100L)	1
51G-3	N030008	Spring Washer (8.3x1.8t)	1	59G-1	A470010	Elevating-Support Cover	1				